

28683** 2.29 (.090) TYPE SERIES - FEMALE CONNECTORS



Specification Receptacle housings

Ways 3

Compatible terminals 4592.**, 4593.**, 4594.**

Thermal Characteristics

Part nr.	Raw material	Color	Flammability Class (UL 94)	Glow Wire Test (GWT) (IEC60695-2-11)	Glow Wire Flammability Index (IEC60695-2-12)	RTI electrical (Max. Operating Temp.)
2868340	NO FLAME	Natural	V2	750°C	960°C	130°C
2868390	PBT	Natural	HB	(T.B.D.)	850°C	120°C

For other materials and colors ask to: info@escubedo.com

Insertion / Withdrawal forces

	2868340
Terminal from connector cavity. Withdrawal force (min)	35N ¹

¹ Valid for 4592.**, 4593.**, 4594.**

Drawing

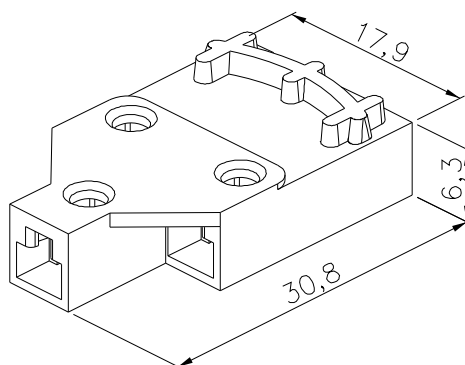

(T.B.D.): To be determined

Disclaimer

Data obtained from Escubedo Laboratory essays, using own methodology, cablings, equipment and original crimping tools, done in laboratory conditions and following the indicated standards, errors and omissions excepted. This document has no contractual meaning and it is publicised only for informative purposes. It can be changed without prior notice. The end customer has the sole responsibility to check these characteristics in its environment and with its own components, manufacturing methods and equipment. See also the full range product overview if available. For further information please visit our web site or contact us

Rev. Nr.	Concept	Date	Created/Revised	Approved
A2	Add Withdrawal Efforts for material 40	2026-02-05	O.Roura (Engineering Dept.)	E.Roura (Laboratory Dept.)
A1	Datasheet generated automatically [A1]	2025-09-29	O. Roura (Engineering Dept.)	E. Roura (Laboratory Dept.)

Escubedo Connection Systems, S.A.U. · 17843 Riudellots de la Creu · Girona · Spain
 Tel.: 34 972 171 706 · Fax: +34 972 171 714 · info@escubedo.com · www.escubedo.com