

28693** 2.29 (.090) TYPE SERIES · FEMALE CONNECTORS



Specification Receptacle housings

Ways 3

Thermal Characteristics

Part nr.	Raw material	Color	Flammability Class (UL 94)	Glow Wire Test (GWT) (IEC60695-2-11)	Glow Wire Flammability Index (IEC60695-2-12)	RTI electrical (Max. Operating Temp.)
2869340	NO FLAME	Natural	V2	750°C	960°C	130°C
2869390	PBT	Natural	HB	(T.B.D.)	850°C	120°C

For other materials and colors ask to: info@escubedo.com

Compatible terminals 4595.**, 4596.**

Insertion / Withdrawal forces

	2869390 / 40
Terminal from connector cavity. Withdrawal force (min)	80N

Drawing

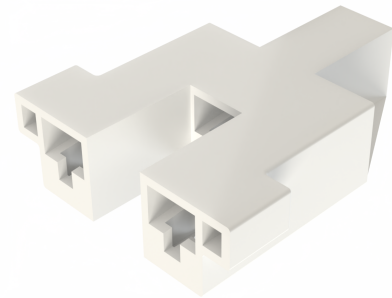
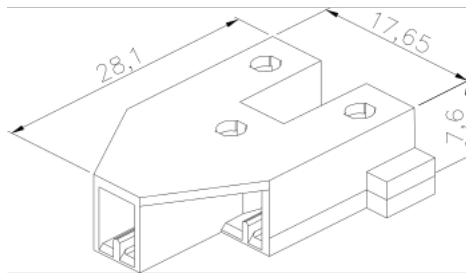

Disclaimer

Data obtained from Escubedo Laboratory essays, using own methodology, cabling, equipment and original crimping tools, done in laboratory conditions and following the indicated standards, errors and omissions excepted. This document has no contractual meaning and it is publicised only for informative purposes. It can be changed without prior notice. The end customer has the sole responsibility to check these characteristics in its environment and with its own components, manufacturing methods and equipment. See also the full range product overview if available. For further information please visit our web site or contact us